

ESCUELA de EDUCACION - UNIVERSIDAD de CONCEPCION

DETALLES de la ESCALERA del 2º al 3º PISO  
ESCALA 0.05 P/M

Pos 720 a 732

*Abimael  
Vergara*

ALBERTO COVARRUBIAS F.  
CARLOS INFANTE C.  
Ingenieros Consultores

DETALLES

26 GRADAS de 16x30  
ESCALA 0.1 P/M

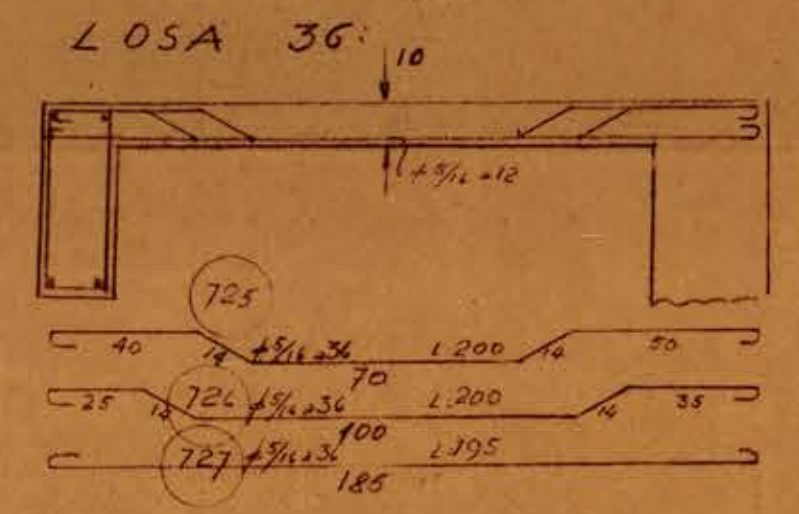
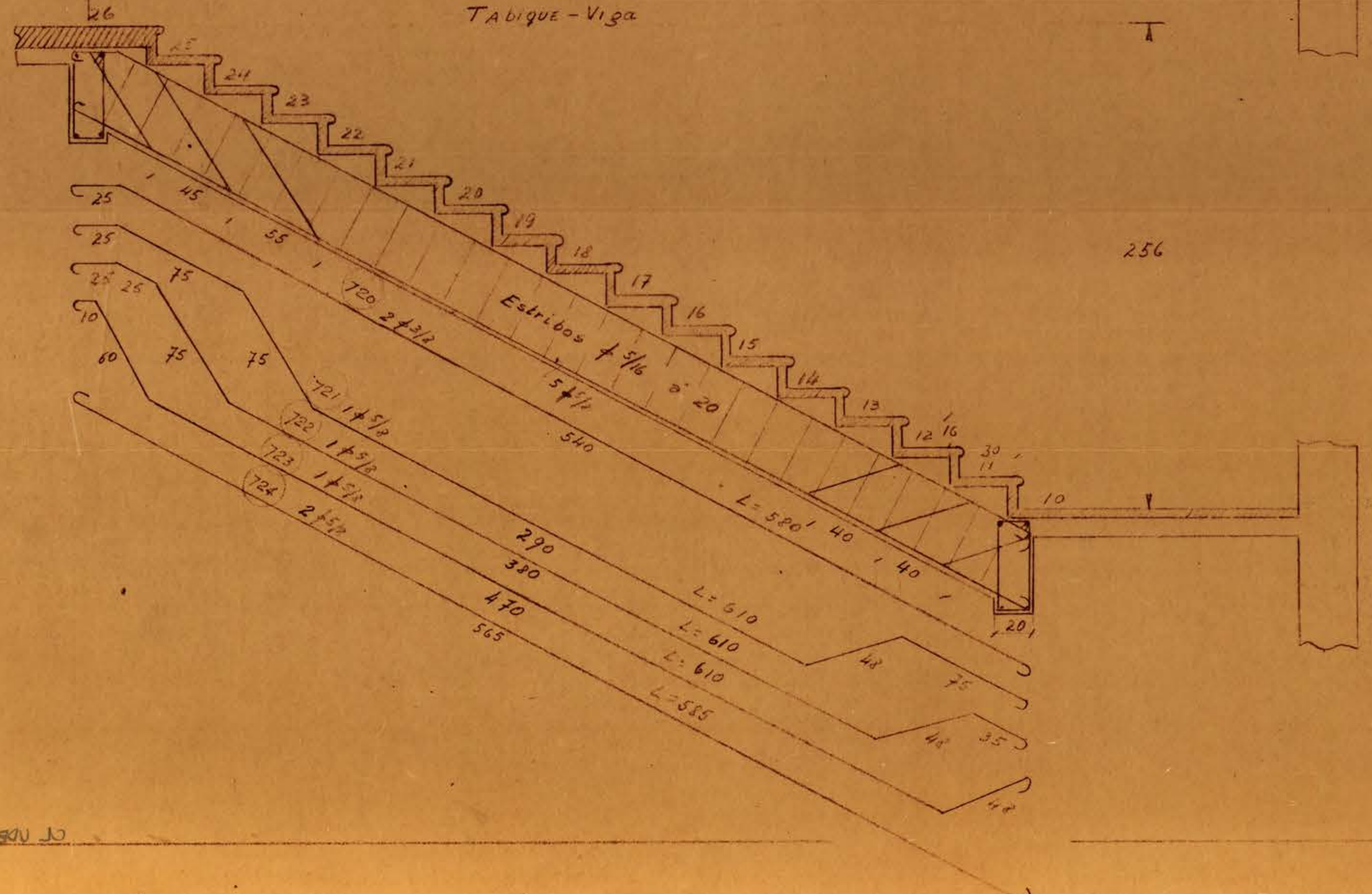
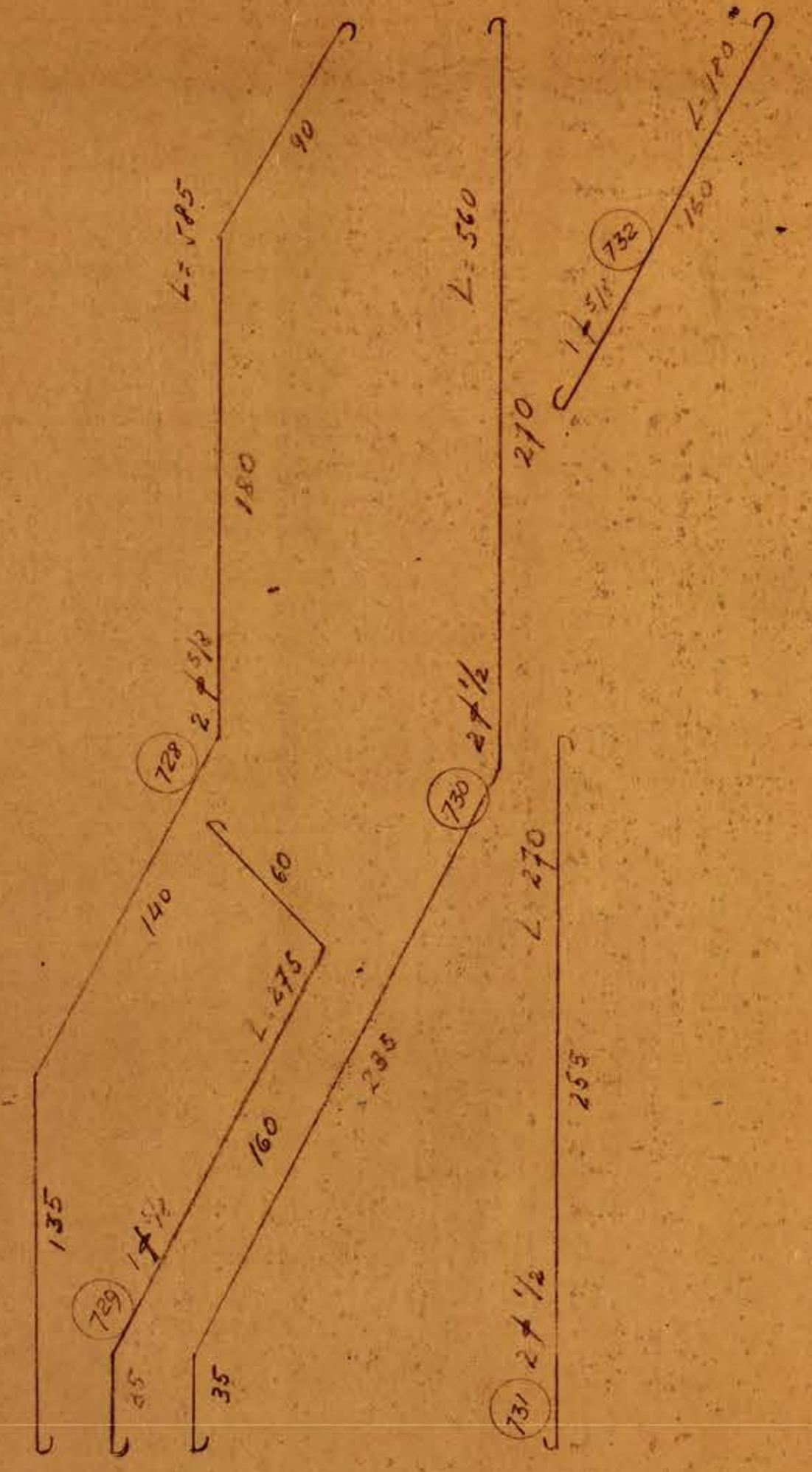
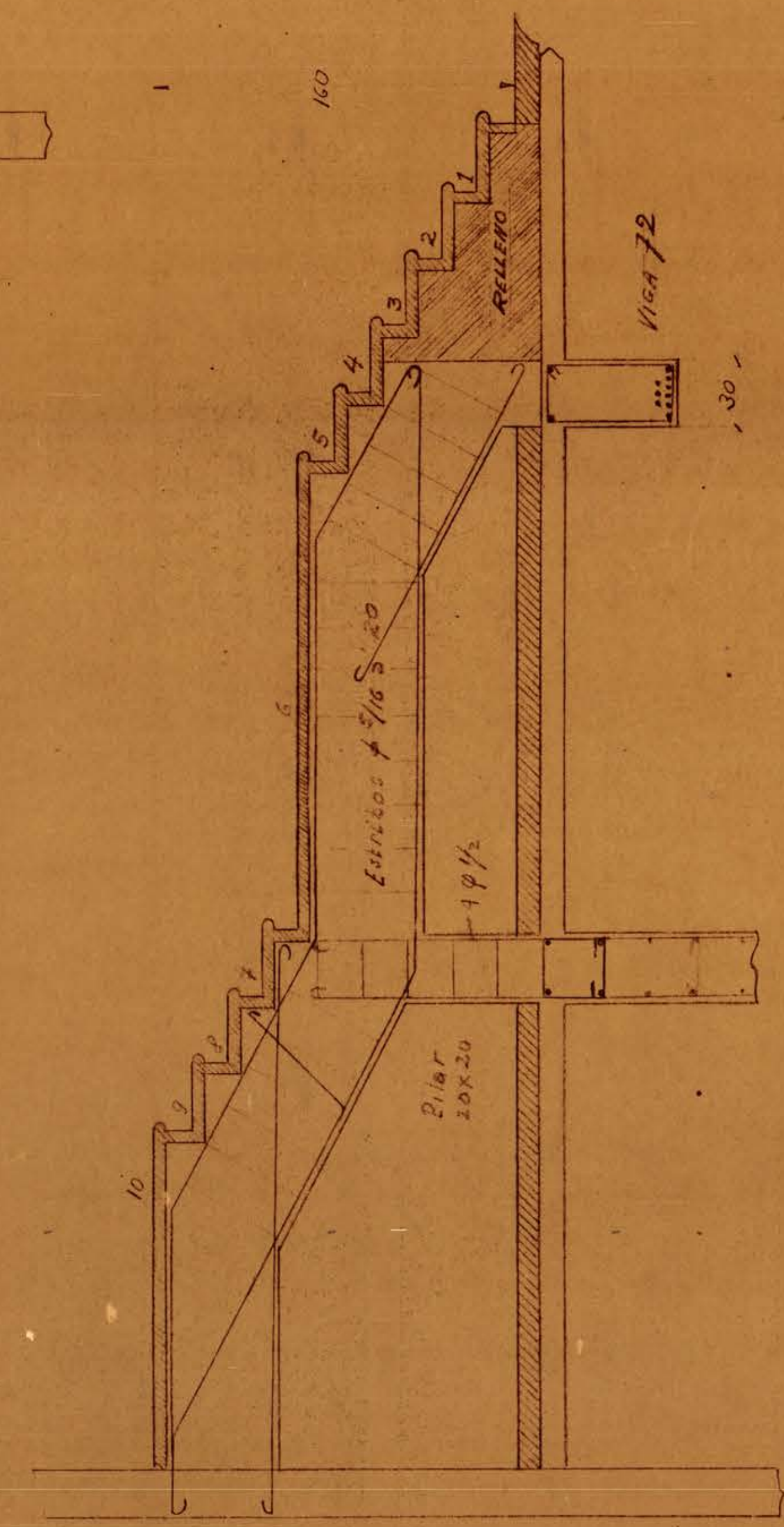
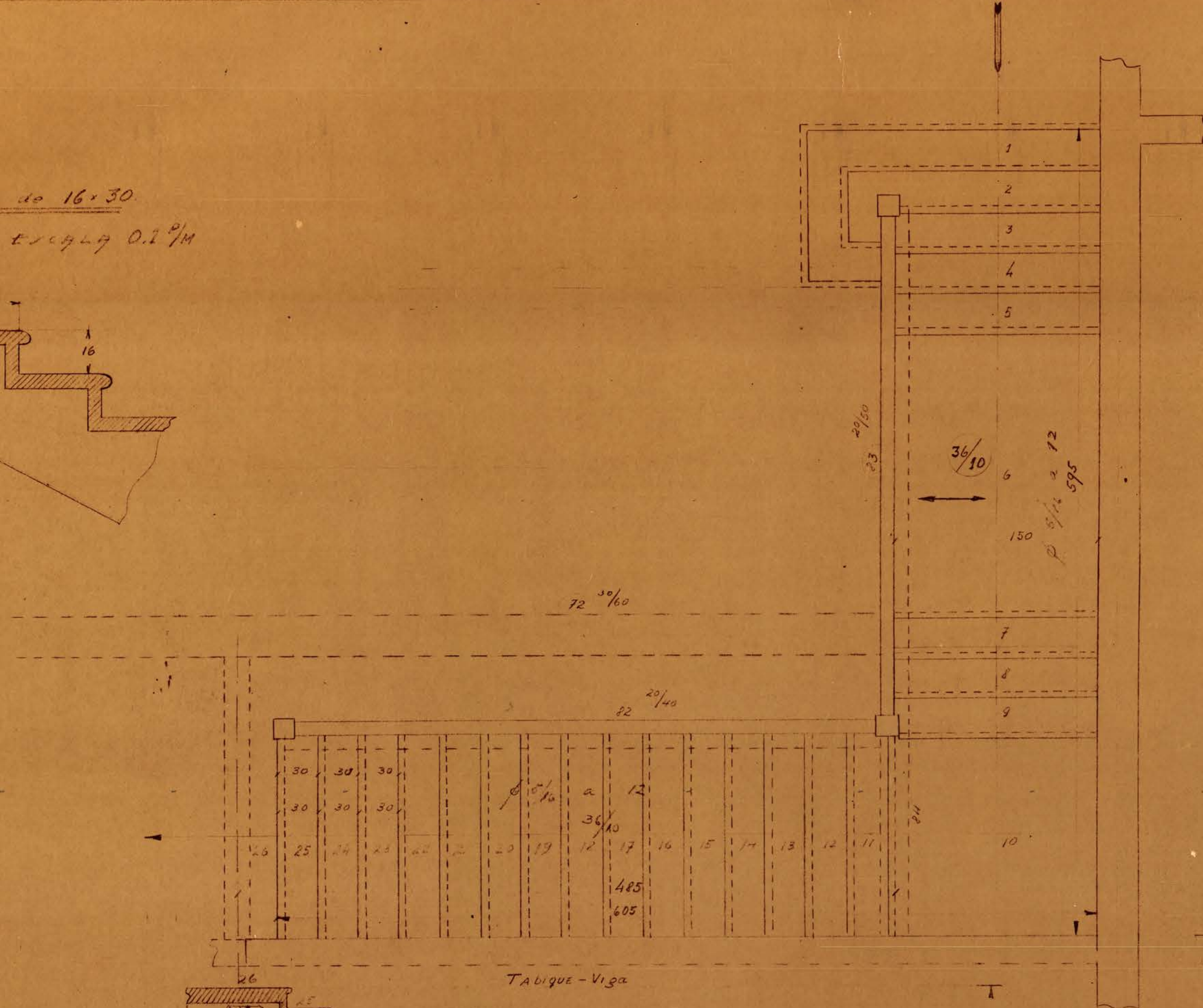
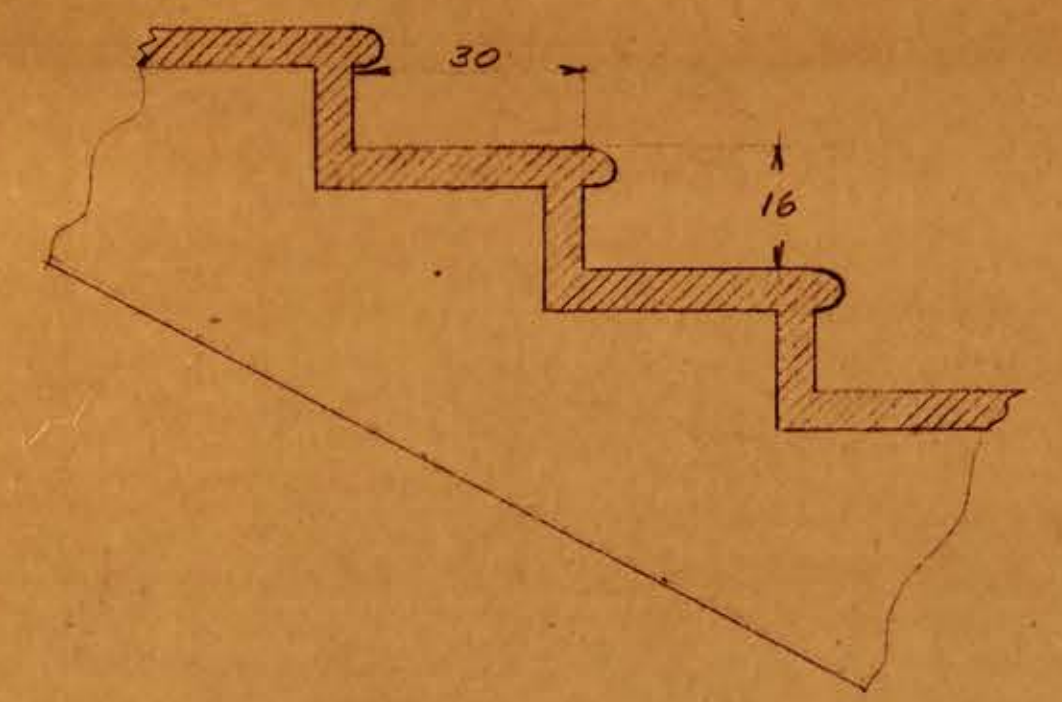

F7